

Rhif y Cais / Application Number : C15/1115/25/LL

Cynllun lleoliad ar gyfer adnabod y safle yn unig. Dim i raddfa.  
Location Plan for identification purposes only. Not to scale.











**REDROW  
HOMES**  
Redrow Homes (NW)  
Redrow Homes, St David's Park, Ffosfabon, CUS 85X  
Tel: 01244 545855 Fax: 01244 552750 Web: www.redrow.co.uk

**BANGOR**

**PENRHOS ROAD**

**Goetre Uchaf**

**Location Plan (Re-Plan)**

**1074-02-02-302**

Scale B/A3 1:2500

Date Started DC

Date May 2015

Checked by

A 250713 Boundary for ownership and application amended CD

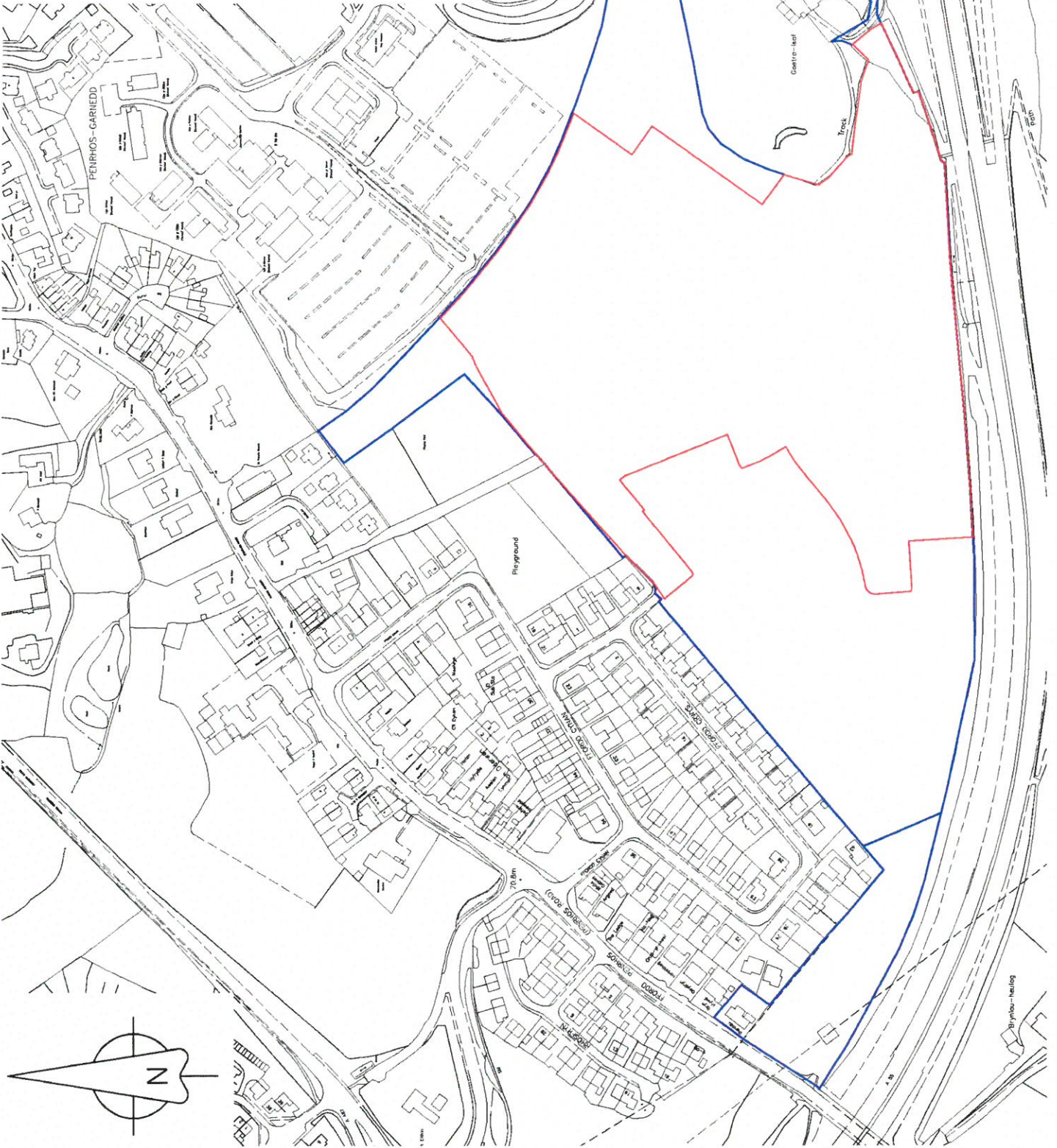



## LAND SOUTH OF PENRHOS ROAD, BANGOR

### 7.0 Previously Approved Layout, Ref: C12/1347/25/LL

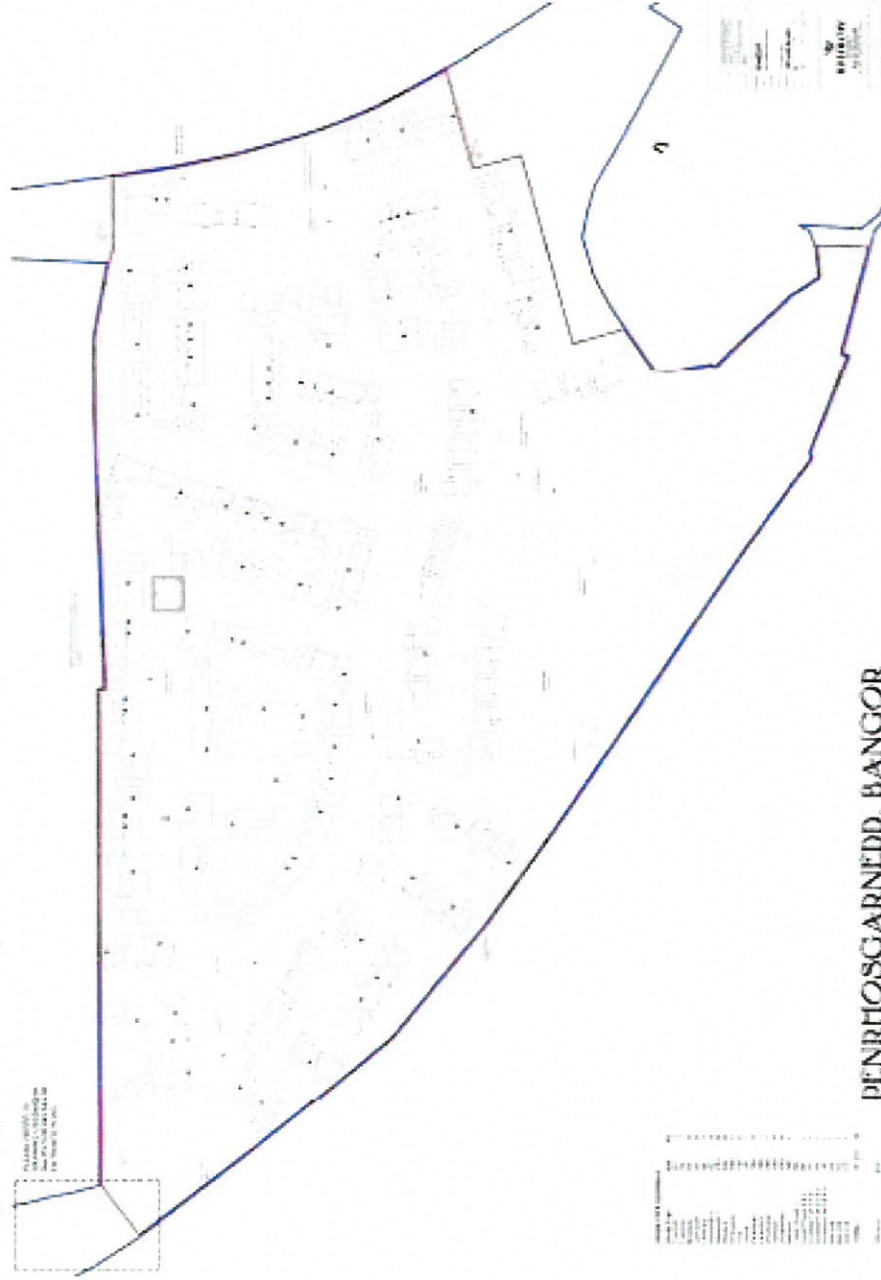

PENRHOSGARNEDD, BANGOR





# LAND SOUTH OF PENRHOS ROAD, BANGOR

## 9.0 House Types



**Hambleton**  
114 sq. ft. | 3 bedrooms



**Hambleton**  
114 sq. ft. | 3 bedrooms



**Stonemas Apartments**



**Letchworth**  
95 sq. ft. | 3 bedrooms



**Shrewsbury**  
114 sq. ft. | 4 bedrooms



**Shrewsbury**  
114 sq. ft. | 4 bedrooms



**Shrewsbury**  
114 sq. ft. | 4 bedrooms



**Letchworth**  
95 sq. ft. | 3 bedrooms



**Shrewsbury**  
114 sq. ft. | 4 bedrooms



**Shrewsbury**  
114 sq. ft. | 4 bedrooms



**Shrewsbury**  
114 sq. ft. | 4 bedrooms



**Warwick**  
103 sq. ft. | 3 bedrooms



**Sustrand**  
114 sq. ft. | 4 bedrooms



**Cambridge**  
114 sq. ft. | 4 bedrooms



**Warwick**  
103 sq. ft. | 3 bedrooms



**Sustrand**  
114 sq. ft. | 4 bedrooms



**Cambridge**  
114 sq. ft. | 4 bedrooms



**Oxford**  
114 sq. ft. | 4 bedrooms



**Windzor**  
114 sq. ft. | 4 bedrooms



**Conterbury**  
114 sq. ft. | 4 bedrooms



**Oxford**  
114 sq. ft. | 4 bedrooms



**Windzor**  
114 sq. ft. | 4 bedrooms

The house type mix for the proposed development is shown above and illustrates the high quality housing Redrow believe is the 'best fit' for the scheme. The Arts and Craft styling of the facades in a modern context is timeless and extremely popular. This design styling creates houses that will sit well in the setting of this development alongside/opposite other house style in the local vernacular.

