

Map, Table and Photographs of Signs, Gates and Barrier at Treborth Hall

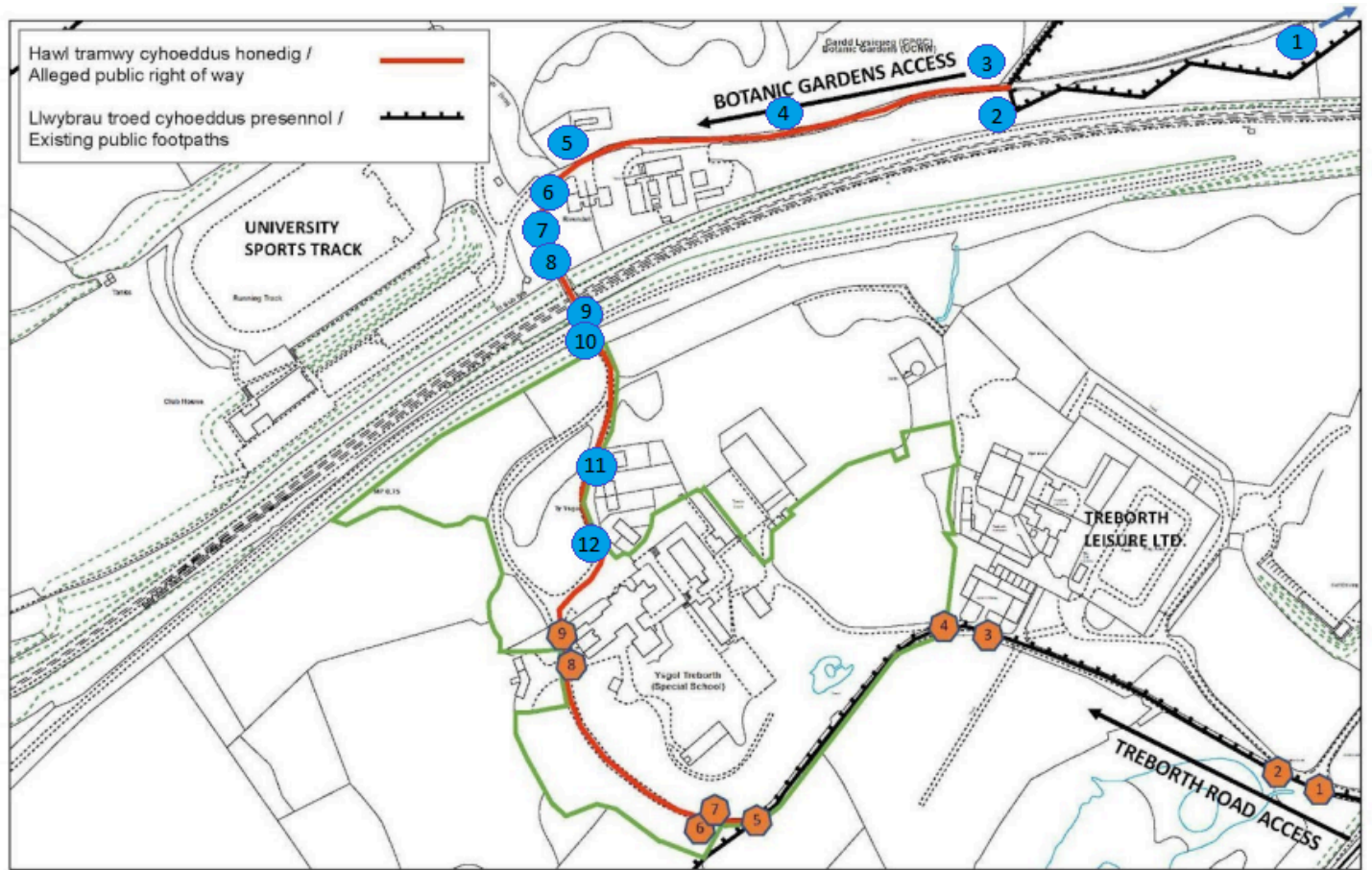

MAP KEY

- Green Line - Property Boundary
- Black Line - Existing Public Footpath
- Red Line - Proposed Public Footpath
- Orange Numbered Symbols - Treborth Road Access Direction
- Blue Numbered Symbols - Botanic Gardens Access Direction

TABLE

Number on Map	Type	Description	In situ prior to our ownership in 2014	Situated on our property
TREBORTH ROAD ENTRANCE				
1	Sign	No-through road sign stating "Access to School and Treborth Farm only".	Yes Please note, Treborth Farm is also known as Treborth Hall Farm and is owned by Treborth Leisure Ltd.	No - Council owned
2	Signs	1) No-through road sign 2) 'Access to School and Treborth Farm and Leisure Ltd Only'. 3) 'No entry to Athletics Track'	Yes	No - Council owned
3	Sign	No-through road sign	Yes	No - Council owned
4	Gates and Signs	1) Treborth Road access gate to the front of Treborth Hall (left-hand gate). With the following signs: A. Private Grounds No-Through Access B. Please Shut the Gate C. CCTV in operation D. Dogs Loose 2) Treborth Road access gate to the rear of Treborth Hall (right-hand gate). With the following signs: A. Private No Public Right of Way B. CCTV in operation C. Dogs Loose	1) Yes (gate installed c.2011) All signs added in 2014 on purchase. 2) Yes All signs were added in 2018 when the Riding for the Disabled closed. Before 2018 an RDA sign and a private riding school sign was in situ.	Yes
5	Sign	Red kissing gate and Public footpath arrow signs directing the public over the field to Treborth Uchaf or to Treborth Road, diverting the public away from the Hall/former School.	Yes	Yes
6	Sign	Sign stating - 'Private no public access or right of way'	No - Sign added in 2014 on purchase	Yes
7	Signs	Signs stating: 1) 'No Thoroughfare' 2) 'Private Grounds No Through Access'	No - Signs added in 2014 on purchase	Yes
8	Gates and Signs	1) Side gate access to the rear of Treborth Hall (right-hand gate). With the following signs: A. 'Danger Dogs Loose' B. 'Private Property keep out' 2) Side gate access to the courtyard of Treborth Hall (left-hand gate). With the following signs: A. 'CCTV in operation' B. 'Polite notice, No Parking, Please Keep Clear'	1) Yes All signs added in 2014 on purchase. 2) Yes All signs added in 2014 on purchase.	Yes
9	Gate and Signs	1) Gate with sign stating 'Private no Public Right of Way' 2) Sign on ground stating 'Private Grounds no through Access' 3) Sign on telegraph pole stating 'No thoroughfare'	No, but gate posts were present on purchase providing evidence of a previous gate. Gate reinstated on purchase. All signs added in 2014 on purchase.	Yes

BOTANIC GARDENS ENTRANCE				
1	Gate	Gate to entrance of the University Botanic Gardens	Yes - We were provided with a key and this was locked at night	No - University Botanical Gardens owned.
2	Sign	Wales Coastal Path Sign	Yes	No - University Botanical Gardens owned.
3	Sign	TBG Signpost 1 (Facing towards Menai Strait) <ol style="list-style-type: none"> To the Menai Bridge Paxton's Cascade Wales Coastal Path TBG Signpost 1 (Facing towards TBG Buildings) <ol style="list-style-type: none"> Glasshouses Rivendell Offices Toilets 	Yes	No - University Botanical Gardens owned.
4	Sign	TBG Signpost 2 (Facing towards Menai Strait) <ol style="list-style-type: none"> Wildlife and Dipping ponds Butterfly border TBG Signpost 2 (Facing towards TBG Buildings) <ol style="list-style-type: none"> Rivendell Offices Toilets TBG Signpost 2 (Facing towards Glasshouses) <ol style="list-style-type: none"> Glasshouses 	Yes	No - University Botanical Gardens owned.
5	Sign	TBG Signpost 3 (Facing towards TBG buildings) <ol style="list-style-type: none"> Glasshouses Toilets TBG Signpost 2 (Facing towards Menai Strait) <ol style="list-style-type: none"> Bog garden Bamboo collection 	Yes	No - University Botanical Gardens owned.
6	Sign	No-through road sign stating "Access to School and Treborth Farm only"	Yes	No - University Botanical Gardens owned.
7	Sign	Sign stating 'No Exit from Sports Ground via this Route'	No - Sign was added c.2018 by the University	No - University Botanical Gardens owned.
8	Barrier	Lockable yellow barrier with a central 'no entry sign'	Yes - We were provided with a key and this was locked prior and on the day of completion.	No - University Botanical Gardens owned.

9	Sign	On tree stating 'No Thoroughfare'	No - Signs added in 2014 on purchase.	Yes
10	Sign	On tree stating 'Private No Public Access or Right of Way'	No - Sign added in 2014 on purchase.	Yes
11	Signs	Signs on fence stating: 1) 'Private Grounds No Through Access' 2) 'No Thoroughfare'	No - Signs added March 2021	No (on son's property)
12	Signs	Signs stating: 1) 'Private No Public Access or Right of Way' 2) 'No Access, Exit gate locked'	No - Signs added in 2014 on purchase.	Yes

PHOTOGRAPHS

TREBORTH ROAD ENTRANCE

Photograph - 1 (On existing Public Footpath)

No-through road sign stating "Access to School and Treborth Farm only"



Photograph - 2 (On existing Public Footpath)

No-through road, 'Access to School and Treborth Farm and Leisure Ltd Only' and 'No entry to Athletics Track' signs



Photograph - 3 (On existing Public Footpath)
No-through road sign



Photograph - 4
Both Gates



Photograph - 4(1) (On existing Public Footpath)

Treborth Road access gate 1 to front of Treborth Hall (left-hand gate) with the following signs: Private Grounds No-Through Access, Please Shut the Gate, CCTV in operation and Dogs Loose.



Photograph - 4(2) (Not on existing Public Footpath)

Treborth Road Access gate 2 to the rear of Treborth Hall (right-hand gate). With the following signs: Private No Public Right of Way, CCTV in operation and Danger Dogs Loose.



Photograph - 5 (On Public Footpath)

Red kissing gate and two footpath arrow signs. One directs the public over the field and the other to Treborth Road. Both arrow signs divert the public from the Hall / School. There is no arrow sign pointing towards the Hall.



Photograph - 6 (Not on existing Public Footpath)

Sign stating - 'Private no public access or right of way'



Photograph - 7 (Not on existing Public Footpath)

Signs stating: 'No Thoroughfare' and 'Private Grounds No Through Access'



Photograph - 8 (Not on existing Public Footpath)

Side gate access to the rear of Treborth Hall (right-hand gate). With the following signs: 'Danger Dogs Loose' and 'Private Property keep out'

Side gate access to the courtyard of Treborth Hall (left-hand gate). With the following signs: 'CCTV in operation' and 'Polite notice, No Parking, Please Keep Clear'



Photograph - 9 (Not on existing Public Footpath)

Gate with sign stating 'Private no Public Right of Way', Sign on ground stating 'Private Grounds no through Access' and Sign on telegraph pole stating 'No thoroughfare'



TREBORTH BOTANIC GARDEN (TBG) ENTRANCE

Photograph - 1 (On existing Coast Path)
Gate to the entrance of the TBG



Photograph 2 (On existing Coast Path)
Wales Coastal Path sign



Photograph 3 (on existing Coast Path)
Coastal path sign TBG signpost 1



There are six arrows on this signpost:

TBG Signpost 1 (Facing towards Menai Strait) directs members of the public to:

- 1.To the Menai Bridge
- 2.Paxton's Cascade
- 3.Wales Coastal Path

TBG Signpost 1 (Facing towards TBG Buildings) directs members of the public to:

- 4.Glasshouses
- 5.Rivendell Offices
- 6.Toilets

Photograph 4 (on TBG - not a public highway)
Coastal path sign TBG signpost 2



There are 5 arrows on this signpost:

TBG Signpost 2 (Facing towards Menai Strait) directs members of the public to:

1. Wildlife and Dipping ponds
2. Butterfly border

TBG Signpost 2 (Facing towards TBG Buildings) directs members of the public to:

3. Rivendell Offices
4. Toilets

TBG Signpost 2 (Facing opposite Glasshouses) directs members of the public to:

5. Glasshouses

Photograph 5 (on TBG - not a public highway)
Coastal path sign TBG signpost 3



There are 4 arrows on this signpost:

TBG Signpost 3 (Facing towards Menai Strait) directs members of the public to:

- 1.Bog garden
- 2.Bamboo collection

TBG Signpost 3 (Facing towards TBG Buildings) directs members of the public to:

- 3.Glasshouses
- 4.Toilets

Photograph - 6 (Not on existing Public Footpath)

No-through road sign and sign stating "Access to School and Treborth Farm only"



Photograph - 7 (Not on existing Public Footpath)

Sign stating 'No Exit from Sports Ground via this Route'



Photograph - 8 (Not on existing Public Footpath)
Lockable yellow barrier with a central 'no entry sign'



Photograph - 9 (Not on existing Public Footpath)
On tree stating 'No Thoroughfare'



Photograph - 10 (Not on existing Public Footpath)
On tree stating 'Private No Public Access or Right of Way'



Photograph - 11 (Not on existing Public Footpath)
Signs on fence stating: 'Private Grounds No Through Access' and 'No Thoroughfare'



Photograph - 12 (Not on existing Public Footpath)

Signs stating: 'Private No Public Access or Right of Way' and 'No Access, Exit gate locked'

