

The restriction on the use of LJ and TJ due to the proximity of floodlight pylons was removed in summer 2002 when the pylons were moved to the outside of the track.

Last update: 25/10/2002

Please send any amendments to [Tim Grose](#)

[UK Running Track Directory](#)
© Copyright Tim Grose 2003

Dear Mr and Mrs Margetson,

I am writing to you today in response to your correspondence of 11 October 2022 and the matters that you have brought to the University's attention.

I have investigated the concerns raised and thank you for your patience and understanding whilst I completed my enquiries. I appreciate that this matter is important to you and I have carefully considered the items raised.

Please find our response as follows;

Submissions of 'Definitive Map Modification Orders' / Public Right of Way forms

- Our enquiries confirm that the submissions were made independently of consultation with Bangor University.
- In respect of the University staff or volunteers that submitted forms, they were made in a personal capacity and are not endorsed by Bangor University.
- Due to this, the University is unable to comment on the content of the forms and suggests that you bring your concerns to the attention of the authority that is considering the information provided.

Access

- The University does not wish to claim any legal right of way over your property, nor does the University encourage or endorse passage by staff or others associated with the Treborth Botanic Garden.
- Our enquiries did not determine that individual staff routinely use the route in question and we have been assured that public routes are recommended to staff and volunteers. We apologise for any inconvenience or distress caused if staff or volunteers have passed through your grounds without your consent at any time now or previously.
- Passage through your property is not endorsed by the University and we will contact all staff and volunteers that use the Treborth Botanic Garden with instructions that they should use the public entry and exit to the site only.
- We understand that members of the general public may access the area for reasons that are unrelated to the Treborth Botanic Garden and note that there is signage in place which deters use of the route. However we will review the signage in place and consider whether this can be improved. Additionally staff / volunteer inductions will be reviewed in case information about access can be more clearly communicated.

Correspondence

- Thank you for your cooperation with past events at the site. The University values relationships with its neighbours and hopes that the future brings similar cooperative events.
- We have addressed your concerns regarding not receiving replies to emails that you have sent. We apologise for any inconvenience that this may have caused.
- We encourage good neighbourly relations and there is a responsibility on all parties to communicate politely. We have reminded our staff of this expectation.
- Please send future emails regarding the Treborth Botanic Garden to myself directly [REDACTED] We aim to respond within 3 working days wherever possible.
- Should you have any future concerns, please contact myself as Head of Estates Management at [REDACTED] and in the event that we are unable to resolve matters, you can escalate your concerns to a Senior Officer at complaints@bangor.ac.uk.

Please note that this response is in accordance with the Bangor University General Complaints Procedure. We hope that this brings you some assurance as to the actions that we have taken and/or will take to address your concerns. However if you remain dissatisfied following this response, you can escalate your complaint further.

If you wish to do so, please contact complaints@bangor.ac.uk, and explain why the outcome of the previous action is not considered satisfactory. Please also identify (if appropriate), any desired outcome that you are seeking to resolve the complaint.

Thank you once again for bringing this matter to our attention.

Yours sincerely

[REDACTED]

Mr Wayne Jones
Head of Estates Management

From: [REDACTED]
To: [REDACTED]
Subject: Treborth Hall - Wayleaves-reply and right of access
Date: Fri, 30 Oct 2015 14:30

Dear Mr and Mrs Margetson,

I refer to your e-mail of the 21 October 2015.

There was only one gate in situ (from the Treborth Road side) when the property was sold at auction, and this was subject to a combination lock. The freehold property sold to yourselves was not sold subject to any other gates.

You are correct in respect of the public footpath as I'm sure you have checked the route carefully, and the rights of your neighbours are clearly documented in the Transfer documents to yourself and to them - copies available at the Land registry. You cannot impose any more onerous restrictions on your neighbours without their consent.

I confirm that we will continue to remind the Football club as to the terms of their Lease.

I'm sorry that the Council is not in a position to assist further in respect of these issues.

If there is to be any further correspondence, I suggest your solicitor contact the Council's Legal Department directly.

Regards,

Lowri Cadwaladr Owen

Uwch Syrfewr Stadau

Senior Estates Surveyor

From: [REDACTED]
Sent: 21 October 2015 15:20
To: Owen Lowri Cadwaladr (Rh-CTGC)
Subject: Re: Treborth Hall - Wayleaves-reply and right of access

Afternoon Lowri

We hope you are well and thank you for your reply regarding any wayleaves.

We have had a meeting last week with Sgt Francis and another PC regarding antisocial behaviour.

We did not inform you that the second gate adjacent to the football club was stolen earlier this year. This is the gate you and Christie Security verbally advised us to reinstate and lock to prevent access onto our freehold property from the public and members of the football club. Please be assured we have a large excess on our insurance policy and we are not claiming for the continual damage occurring on our property.

Now the two gates from the Treborth Road entrance have been stolen.

We are perturbed with the advice given by the PC regarding antisocial behaviour, as we understand he has been in contact with you.

We do not agree with what he has told us and we would like to clarify this matter with you please.

As we understand it, we purchased the freehold title from Gwynedd Council with locked gates:

1. Gate from Treborth Road – locked with a combination lock.
2. Gate from the Botanical Gardens – locked with a padlock – key supplied by the University.
3. Yellow barrier – key supplied from Gwynedd Council.

According to the information provided by our solicitor no other party has the right of unrestricted access over any of our title. Our neighbours have only a right of access across our freehold title. They do not share ownership of the roads providing their right of access over our property.

As Gwynedd marketed the Estate as being private on purchase, we are somewhat at a loss as to why:

1. 1. Members of the public believe they have a right of way across our property from Treborth Road. We appreciate you sold us a property with a public footpath up our private lane which ends half way. No member of the public has the right to continue past this point.
2. 2) Our neighbours of Ty Coed Menai believe they have unrestricted rights over access. Why has Gwynedd Council lead them to believe this?.
- 3) Members of the public and our neighbours are creating a through road without our permission.

T The creation of a through road is devaluing our property.

5.3) Penrhos Football club continues to not adhere to their leasehold agreement, i.e they park on our freehold title and they cross our freehold title to the front of the hall by foot and vehicle. As you are aware they also continue to cause us a nuisance.

We wish to reinstate both gates from the Treborth Road with adequate combination locks so the devaluation of our property does not occur from any third party. We have been advised to inform you of this. As the Council owns some of the adjoining land we wish to know what help you can provide us so we can all securely protect our property.

We would appreciate clarification on the above, as we feel we have been mislead on the rights of the freehold title when we purchased this (as seen) at auction with locked gates in situ and with the second gate identified in a photograph of the school on the internet in the 1970's.

Kind Regards

Mark and Susan Margetson

Treborth Hall

-----Original Message-----

From: Owen Lowri Cadwaladr (Rh-CTGC)

To:

Sent: Wed, 14 Oct 2015 16:33

Subject: Treborth Hall - Wayleaves

Good afternoon,

I hope you are well.

I am not aware of any specific agreements other than what was disclosed as part of the conveyancing process. The contract did however specify that the property was sold subject to "any wayleaves or easements which may affect the property".

Regards,

Lowri

Lowri Cadwaladr Owen

Uwch Syrfewr Stadau

Senior Estates Surveyor

Uned Eiddo Corfforaethol | Corporate Property Unit

Cyngor Gwynedd | Gwynedd Council

Caernarfon

LL55 1SH

From:

Sent: 14 October 2015 15:09

To: Owen Lowri Cadwaladr (Rh-CTGC)

Subject: Treborth Hall - Wayleaves

Afternoon Lowri

Hope you are well.

Sorry to trouble you, but can you please clarify whether wayleaves were granted for the black BT box and wiring attached to the front of Treborth Hall supplying the former staff houses and with Scottish Power or any other energy company with regard to the cables and pylons crossing our freehold title.

Many thanks

Mark and Susan Margetson

Mae'r e-bost hwn ac unrhyw atodiad iddo yn gyfrinachol ac fe'i bwriedir ar gyfer y sawl a enwir arno yn unig. Gall gynnwys gwybodaeth freintiedig. Os yw wedi eich cyrraedd trwy gamgymeriad ni ellwch ei gopio, ei ddosbarthu na'i ddangos i unrhyw un arall a dylech gysylltu â'r anfonwr ar unwaith.

Mae unrhyw gynnwys nad yw'n ymwneud â busnes swyddogol y corff sy'n anfon yr e-bost yn bersonol i'r awdur.

This email and any attachments are confidential and intended for the named recipient only. The content may contain privileged information. If it has reached you by mistake, you should not copy, distribute or show the content to anyone but should contact the sender at once.

Any content that is not pertinent to the official business of the organisation is personal to the author.

Arbedwch bapur, ynni ac arian - Peidiwch argraffu'r neges yma oni bai ei bod yn hollol angenrheidiol.

Save paper, energy and money - Do not print this message unless it is absolutely necessary.

Mae'r e-bost hwn ac unrhyw atodiad iddo yn gyfrinachol ac fe'i bwriedir ar gyfer y sawl a enwir arno yn unig. Gall gynnwys gwybodaeth freintiedig. Os yw wedi eich cyrraedd trwy gamgymeriad ni ellwch ei gopio, ei ddosbarthu na'i ddangos i unrhyw un arall a dylech gysylltu â'r anfonwr ar unwaith.

Mae unrhyw gynnwys nad yw'n ymwneud â busnes swyddogol y corff sy'n anfon yr e-bost yn bersonol i'r awdur.

This email and any attachments are confidential and intended for the named recipient only. The content may contain privileged information. If it has reached you by mistake, you should not copy, distribute or show the content to anyone but should contact the sender at once.

Any content that is not pertinent to the official business of the organisation is personal to the author.

Arbedwch bapur, ynni ac arian - Peidiwch argraffu'r neges yma oni bai ei bod yn hollol angenrheidiol.
Save paper, energy and money - Do not print this message unless it is absolutely necessary.

Occurrence enquiry log report

Version 5f4d1d06 (2020/07/20)

North Wales Police

Occurrence: RC15012946 Theft Other @28/01/2015 08:43 METAL THEFT - STB 1200HRS 270115 AND 1500HRS 270115 UNKNOWN OFFENDER/S HAVE REMOVED A STEEL FIVE BAR FARM GATE FROM LANE LEADING TO THE IP'S DWELLING. GATE WAS BOLTED ONTO THE SUPPORTING POSTS AND WAS SECURED WITH A METAL CHAIN AND PADLOCK, BOTH ALSO REMOVED FROM THE SCENE.

Task status: All

Log type: All

#	Type	Entry time	Event time	Author	Link	Task
1	Investigator action	28/01/2015 09:40	28/01/2015 09:40	#6090348 THOMAS, JANETTE	No	

Log entry: IST INVESTIGATION TEMPLATE.

CIRCUMSTANCES: STB 1800HRS 270115 AND 0830HRS 280115 UNKNOWN OFFENDER/S HAVE REMOVED A STEEL FIVE BAR FARM GATE FROM LANE LEADING TO THE IP'S DWELLING. GATE WAS BOLTED ONTO THE SUPPORTING POSTS AND WAS SECURED WITH A METAL CHAIN AND PADLOCK, BOTH ALSO REMOVED FROM THE SCENE. THE IP STATED THAT TOOLS AND A VAN OF SOME SORT WOULD HAVE BEEN USED AS THE GATE WAS VERY HEAVY.

THE LANE IS ACCESS TO HER DWELLING AND IS SITUATED APPROX 1/2 MILE AWAY FROM HER DWELLING. THERE IS ALSO A SECOND GATE NEARER TO THE IP'S DWELLING WHICH HAS BEEN LEFT IN SITU.

THE NEAREST NEIGHBOURS ARE A RIDING SCHOOL WHO HAVE A RIGHT OF ACCESS TO USE THE GATE AND HAVE BEEN PROVIDED WITH KEY BY THE IP. THE IP WILL MAKE ENQUIRIES WITH THE RIDING SCHOOL TO ESTABLISH IF ANYTHING HAS BEEN SEEN OR HEARD BEFORE THEY CLOSED LAST NIGHT (NO ONE IS RESIDENT ON THE SITE).

A LOCAL FOOTBALL CLUB ALSO HAVE A RIGHT OF ACCESS AND A KEY FOR THE GATE BUT THE IP DOES NOT BELIEVED THAT THERE WAS A GAME OR TRAINING LAST NIGHT.

SOLVABILITY FACTORS:
Solvability Factors have been considered

- 1) Likelihood of identifying suspect (CCTV enquiries) CCTV AT THE HALL BUT GATE SITUATED APPROX 1/2 MILE AWAY FROM THE MAIN HOUSE.
- 2) Identification Evidence (IP or witness, house to house enquiries) IP WILL MAKE ENQUIRIES WITH THE NEARBY RIDING SCHOOL
- 3) Identification of property (BOF / A/D process / E-Bay / Financial cheques, cards / Mobile phones / Found Property book) HEAVY STEEL 5 BAR FARM GATE, CHAIN AND PADLOCK - VALUE NOT KNOWN - NOTHING IDENTIFIABLE ABOUT THE GATE AND WAS INSTALLED BY THE LOCAL COUNCIL WHEN THE IP'S DWELLING WAS ORIGINALLY UP FOR SALE SOME TIME AGO.
- 4) Forensic Opportunities (F/Prints / DNA / Footwear / Chemical Treatment) Intelligence (similar MO crimes / active suspects) NONE - ALL ITEMS REMOVED FROM SCENE - NOTHING LEFT BY OFFENDER AT THE SCENE. HEAVY RAIN OVERNIGHT.
- 5) Other areas for consideration (Media strategy / warrants / cross border liaison / local knowledge). TAGGED FOR INFORMATION OF RURAL CRIME TEAM AND MARKED AS METAL THEFT.

Special Aggravating Features also considered as reasons why occurrence may be required to be ?screened in?. N/A

ACTION TAKEN / OTHER INFO: (prop investigation) NO WITNESSES, NO SUSPECTS, NO CCTV, NOTHING FOR CSI. THE IP WILL SPEAK WITH THE NEARBY RIDING SCHOOL AND RECONTACT IST. NOT TASKED FOR PCSO TO MAKE ENQUIRIES WITH SCRAP YARDS ARE NOTHING IDENTIFIABLE ON THE GATE.

VULNERABILITY ASSESSMENT

Section 1. Other than this occasion, how often have you had problems whether reported or not?

1 Most months / Within last 6 months - BOTD AT THE LOCATION 290914

If positive result (score 1 or more) - go to questions 2-6 on full vulnerability template. ("SCREEN IN")

Section 2. Which of the following do you think that this incident deliberately targeted

0 None



RE: Treborth Hall - No public right of way

From: [REDACTED]

To: [REDACTED]

Date: Wednesday, 31 July 2019 at 11:55 BST

Dear Mrs Margetson

I am sorry to hear that you having issues with vehicles using your driveway and please be assured that the University does not advertise this as a route into or from our sports facilities. The correct route is made clear to all users and we are happy to remind them again.

Unfortunately we don't have control of people who take it upon themselves to try to take a short cut from the public highway to the north of your property – or for that matter try to use both your driveway and our Treborth road as a detour during periods of peak traffic on the A487/A5. However, I understand that University (via our subcontractor Owen and Palmer) had arranged for a gate to re-installed next to your property in order that you have the ability to prevent unauthorised access and thus completely prevent this issue. If this gate has not been installed please let me know.

This was the agreed course of action following your grateful assistance during some of our recent building works.

As above, we will remind users regarding the correct route of entry and egress to the sports facilities.

Yours sincerely

Richard Bennett

**Richard Bennett**

Cyfarwyddwr Gwasanaethau Masnachol

E-bost: [REDACTED]

Ffôn: 01248 382571

Prifysgol Bangor, Bangor, Gwynedd, LL57 2DG

[!\[\]\(cab4bf952ad41dda9681cfcbefe1a76e_img.jpg\) @prifysgolbangor](https://twitter.com/prifysgolbangor) [!\[\]\(6a493cef2f6f1446d39d4d5ba44f7340_img.jpg\) /PrifysgolBangor](https://www.facebook.com/PrifysgolBangor)**Richard Bennett**

Commercial Services Director

Email: [REDACTED]

Phone: 01248 382571

Bangor University, Bangor, Gwynedd, LL57 2DG

[!\[\]\(6638a56c686f4e4d5e9e12d5a306d03e_img.jpg\) @BangorUni](https://twitter.com/BangorUni) [!\[\]\(712423223c1c19e05f6cca82e78a9b81_img.jpg\) /BangorUniversity](https://www.facebook.com/BangorUniversity)

From: [REDACTED] <[REDACTED]>

Sent: 31 July 2019 11:39

To: [REDACTED]

Subject: Treborth Hall - No public right of way

Good Morning Mr Bennett

As you are aware, there is no public right of way from Treborth Road past the front of Treborth Hall. This is private land.

Mr Sam Wallwork from your department has been made fully aware of this and at the meeting held at Rivendale regarding the installation of fibre optic cable, assured me that all people using the University Sports Facility at Treborth

would be notified that they have no legal right of way past Treborth Hall and must access the sports facility via the University Botanic Gardens.

Yesterday evening there were so many cars driving past the hall that I blocked their access with my car so I could explain the situation. Within a few minutes I had a queue of approximately 30 cars. I have video footage. One of my sons back from University was verbally abused and myself and one of our workmen were nearly run over.

There is a maintenance cost for my drive and this situation needs to be rectified immediately. I have spoken to the Vice Chancellor's office and told them I am sending this email to you in the hope of finding an amicable resolution.

I would be appreciative of your assistance in this matter and look forward to hearing from you.

Best regards

Susan Margetson (Mrs)

Mae croeso i chi gysylltu gyda'r Brifysgol yn Gymraeg neu Saesneg

You are welcome to contact the University in Welsh or English

Rhif Elusen Gofrestredig 1141565 - Registered Charity No. 1141565

Gall y neges e-bost hon, ac unrhyw atodiadau a anfonwyd gyda hi, gynnwys deunydd cyfrinachol ac wedi eu bwriadu i'w defnyddio'n unig gan y sawl y cawsant eu cyfeirio ato (atynt). Os ydych wedi derbyn y neges e-bost hon trwy gamgymeriad, rhowch wybod i'r anfonwr ar unwaith a dilewch y neges. Os na fwriadwyd anfon y neges atoch chi, rhaid i chi beidio a defnyddio, cadw neu ddatgelu unrhyw wybodaeth a gynhwysir ynddi. Mae unrhyw farn neu safbwynt yn eiddo i'r sawl a'i hanfonodd yn unig ac nid yw o anghenraid yn cynrychioli barn Prifysgol Bangor. Nid yw Prifysgol Bangor yn gwarantu bod y neges e-bost hon neu unrhyw atodiadau yn rhydd rhag frysau neu 100% yn ddiogel. Oni bai fod hyn wedi ei ddatgan yn uniongyrchol yn nhestun yr e-bost, nid bwriad y neges e-bost hon yw ffurfio contract rhwymol - mae rhestr o lofnodwyr awdurdodedig ar gael o Swyddfa Cyllid Prifysgol Bangor.

This email and any attachments may contain confidential material and is solely for the use of the intended recipient(s). If you have received this email in error, please notify the sender immediately and delete this email. If you are not the intended recipient(s), you must not use, retain or disclose any information contained in this email. Any views or opinions are solely those of the sender and do not necessarily represent those of Bangor University. Bangor University does not guarantee that this email or any attachments are free from viruses or 100% secure. Unless expressly stated in the body of the text of the email, this email is not intended to form a binding contract - a list of authorised signatories is available from the Bangor University Finance Office.

FW: Treborth Hall

From: Edwards Ruth Elisabeth (TA) [REDACTED]

To: [REDACTED]

Date: Wednesday, 25 September 2019 at 11:34 BST

Dear Mrs Margetson – thank you for bearing with me whilst I obtained copies of all the documentation . I will try and deal with the points you have raised in turn:-

[REDACTED]

3) I have looked at the football club lease. They have a right of way at all times over the road coloured yellow on the second plan above. You are concerned that they are using the access via the Botanic Garden. We will strongly emphasise to them they are not authorised to do this. I understand from our telephone discussion that you have placed a lock on the gate which was already present when you purchased the Hall. Obviously if the lock is to remain in place there will have to be an element of co operation and common sense . As is the position at the minute we suggest that the lock remains on the gate and with access / key to the club but that the gate remains unlocked whilst the Club has training (Mon – Fri 5pm- 8pm April to the end of October)and during matches on Saturday and Sunday mornings .Given the volume of traffic I am sure you will appreciate it is not practicable for the gate to be locked during these times. We have also written to the Club emphasising that they **only** have a right of way over the yellow road, that they need to control the flow of traffic to avoid grid-lock and they need to lock the gate at the end of training and when the matches have finished.

As stated by yourself these issues should be capable of amicable settlement .Hopefully with a small amount of consideration by both parties this can be achieved.

Thank you again for allowing me the time to look into this matter and I hope I have addressed all of the concerns that you raised.

Ruth Edwards

Cyfreithiwr/Solicitor

Gwasanaeth Cyfreithiol/Legal Services

Tim Arweinyddiaeth Corfforaethol/Corporate Leadership Team

Cyngor Gwynedd/Gwynedd Council

Ffon/Tel :01286 679039 (est-ext 2039)

Ffacs/Fax:01286 679466

E-bost/E-mail: [REDACTED]

Occurrence enquiry log report

North Wales Police

Occurrence: RC15082382 Theft Other @07/06/2015 21:04 CALLER REPORTING THAT STB 17.00 ON THE 05/06/2015 AND 20.00 ON THE 07/06/2015 A UNKNOWN OFFENDER/S HAVE STOLEN A GATE FROM THE LOCATION. THE GATE WAS FOR THE CAR PARKING AREA. APPROX VALUE OF GATE £500

Task status: All

Log type: All

#	Type	Entry time	Event time	Author	Link	Task
1	Hist - Victim contact 10 days	07/06/2015 23:26	07/06/2015 23:26	#6072775 FRANCIS, No WAYNE	No	
<i>Log entry:</i>	The victim is away from the office until 12/06/2015 and will expect an update on that day.					
2	Investigator action	07/06/2015 23:27	07/06/2015 23:27	#6072775 FRANCIS, No WAYNE	No	
<i>Log entry:</i>	<p>INVESTIGATION DETAILS</p> <p>LOCATION DETAILS: Treborth Hall Old School, Bangor</p> <p>SCENE VISITED? YES</p> <p>...</p> <p>SELF DEFINED ETHNICITY: W1</p> <p>OFFICER DEFINED ETHNICITY: IC1</p> <p>VICTIM SUPPORT (VSS): DECLINED</p> <p>VICTIM OF CRIME LEAFLET ISSUED? NO</p> <p>CRIME PREVENTION ADVICE GIVEN?: YES</p> <p>WITNESS DETAILS : None identified</p> <p>SUSPECT / OFFENDER : None identified</p> <p>SUSPECT VEHICLES : None identified</p> <p>EVIDENTIAL : XXXXX</p> <p>PROPERTY UPDATE: 1 x 7/8" metal farm gate stolen (aprox £500).</p> <p>CIRCUMSTANCES :</p> <p>Please see the released occurrences involving the IP.</p> <p>The IP is currently subject to bail conditions not to attend at the location and as such his wife attended and the matter was discussed with her.</p> <p>The metal gate into the car park area has been stolen between 1700 05/06/2015 - 2000 07/06/2015 by persons unknown. The IP believes that this was done by ... due to the ongoing disputes between him and the MAREGTSONS - at present there is no evidence to substantiate this.</p> <p>..</p> <p>There may be CCTV, but this will take a few days to establish and the IP is arranging this.</p> <p>H2H negative other than the residents of #3 stating that the gate was there yesterday (06/06/2015), but at that point they noticed that the chain and padlock had been cut.</p> <p>They first noticed the gate missing as they passed on the morning of 07/06/2015.</p> <p>TASKS COMPLETED :</p> <p>1. Scene visited;</p> <p>2. Search for the gate;</p> <p>3. ...</p>					
	4	Investigator action	11/06/2015 16:24	11/06/2015 16:24	#6072775 FRANCIS, No WAYNE	
<i>Log entry:</i>	I have called the informant at 16.25hrs 11/06/2015. No reply. message left on voicemail.					
	6	Investigator action	12/06/2015 13:58	12/06/2015 13:58	#6072775 FRANCIS, No WAYNE	
<i>Log entry:</i>	Called the landline number provided at 13.58hrs, voicemail left.					
	7	Investigator action	12/06/2015 15:08	12/06/2015 15:08	#6072775 FRANCIS, No WAYNE	
<i>Log entry:</i>	Called again 15.09hrs - no message left.					
	8	Investigator action	15/06/2015 23:17	15/06/2015 23:17	#6072775 FRANCIS, No WAYNE	
<i>Log entry:</i>	<p>From: Francis, Wayne (A/Sgt 2775)</p> <p>Sent: 15 June 2015 23:06</p> <p>To: [REDACTED]</p> <p>Subject: Contact</p>					

THIS DEED OF LEASE is made the 25 day of September 2013 **BETWEEN GWYNEDD COUNCIL** whose principal Offices are situated at Shirehall Street Caernarfon in the County of Gwynedd (hereinafter called "the Landlord") of the one part and and being **THE TRUSTEES OF CLWB PELDROED PENRHOSGARNEDD** (hereinafter called "the Tenant") of the other part (which expression shall also include their respective successors in title) **NOW THIS LEASE WITNESSETH** as follows:

1. In consideration of the rents hereinafter reserved and the covenants on the part of the Tenant hereinafter contained the Landlord hereby demises unto the Tenant **ALL THAT** parcel of land being approximately 7.4 acres or thereabouts being part of the land known Coed Menai Treborth, Bangor as the same is shown for identification

on the plan attached hereto (the Plan) and thereon edged red together with the building erected thereon (the demised premises) **TOGETHER** with the right of way in order to gain access to the demised premises along the that part of the roadway shown cross-hatched yellow on the attached plan or along any other route agreed in the future with the owner of the road. **EXCEPTING AND RESERVING AS FOLLOWS:**

i) unto the Landlord and all others entitled thereto the right to the continued use of any service media running under the demised premises together with such rights of access as are reasonably necessary to enter upon the demised premises with or without workmen and machinery in order to lay construct connect into maintain repair replace and renew any such service media making good any damage thereby caused ii) unto the Landlord and those authorised by it the right of access onto the demised premises in order to erect any building or to carry out any work or repairs on any adjacent or neighbouring lands of the Landlord but making good any damage thereby caused and to use the adjacent or neighbouring lands and buildings in any manner and for any purpose as the Landlord may think fit notwithstanding that the access of light and air to the demised premises may thereby suffer interference
ii) unto the Landlord and those authorised by it (including the Riding for the Disabled Society) the right of access and egress on foot and with horses and machinery and vehicles along those parts of the demised property shown coloured green on the attached plan for the purpose of gaining access to the nearby land shown edged blue on the attached plan. iv) unto the Landlord and all those authorised by it including Riding for the Disabled Association the right to receive a supply of water from the demised premises.

TO HOLD the demised premises (except and reserved as aforesaid) unto the Tenant for the term of 20 years from the 25 day of March 2013 paying therefore the rent set out in the First Schedule hereto. 2. The Tenant hereby covenants with the Landlord as follows: (a) to pay the said rent at the times and in manner aforesaid without any deduction whatsoever; (b) to pay and discharge all existing and future rates taxes assessments and outgoings (whether parliamentary local or otherwise) now or hereafter imposed or charged upon the owner or occupier of the demised premises save only such as the owner is by law bound to pay notwithstanding any contract to the contrary (c) to pay all charges for any services including any rates taxes electricity water or sewerage supplied to or used at the demised

premises.

(i) A water sub-meter has been installed in the demised premises and the Landlord will take readings and will invoice the tenant for their supply of water in accordance with the tenants use. The Landlord will have the right to charge an administrative fee for taking the readings and for invoicing the tenant and the Landlord together with its employees and agents will have a right to have access to and go on

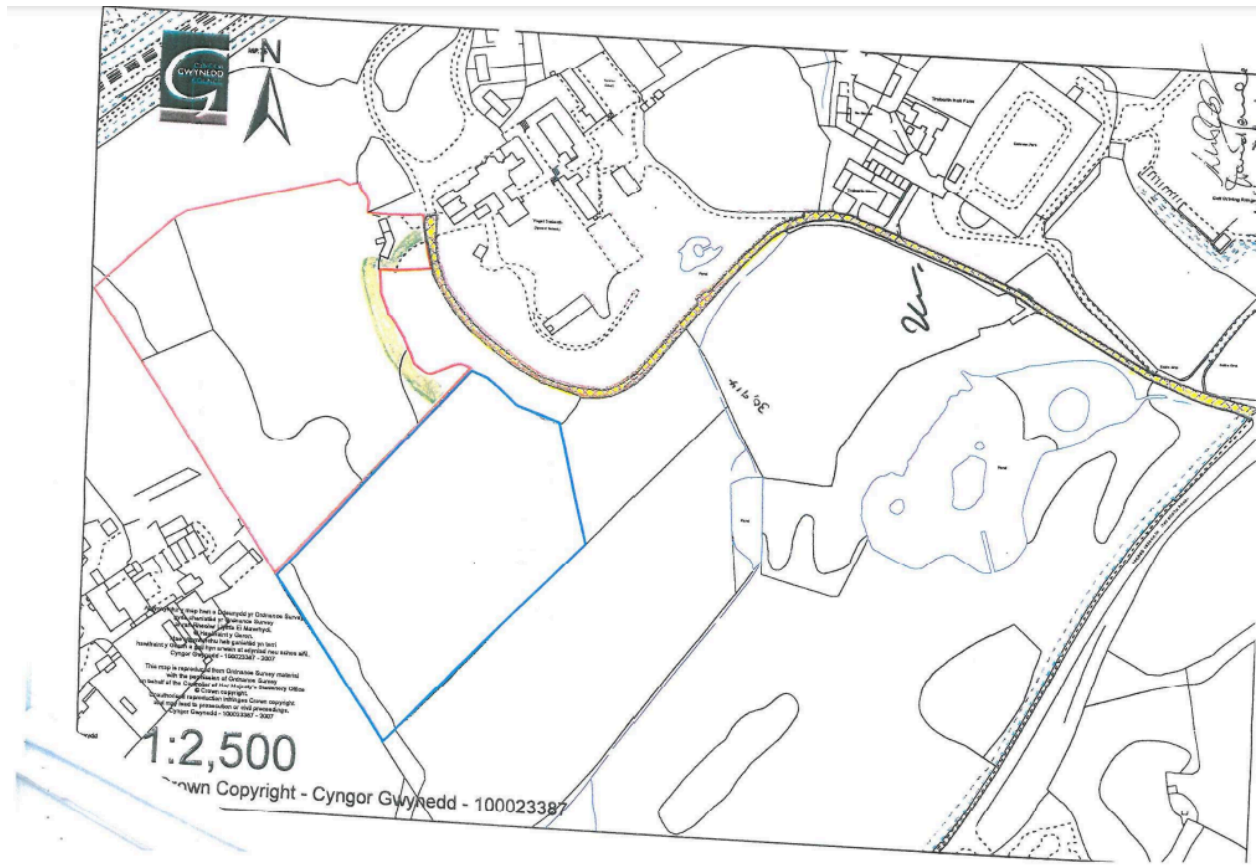

TREBORTH HALL / SCHOOL CAR PARK EVIDENCE

The proposed footpath runs through the former car park of the former school. In 2015 we repositioned the boundary stones from the grass central island to the tarmac where they are positioned currently. At the time, these were moved to stop neighbours parking in front of the hall and to provide a clear specific route for vehicle access to the neighbouring properties and Council leaseholders. Whilst occupied as a school there were 28 car parking spaces, in addition to 2 large bays marked yellow for minibuses directly in front of the Hall.

The photographs below show **no intention** by Gwynedd Council to **dedicate** the specific route proposed as it goes through the car park. Any pedestrian route would be **interrupted** by cars, minibuses, deliveries, visitors etc.using the car park.

Photograph 1 - 1970s aerial photograph

Evidence of the car park and marked parking bays.

Evidence of the side gate circled in red

Evidence of the shrubs/trees to the rear of the grass island



Photograph 2 - Google Earth 2006

12 cars parked in the 13 car parking spaces on the proposed route (indicated in red)

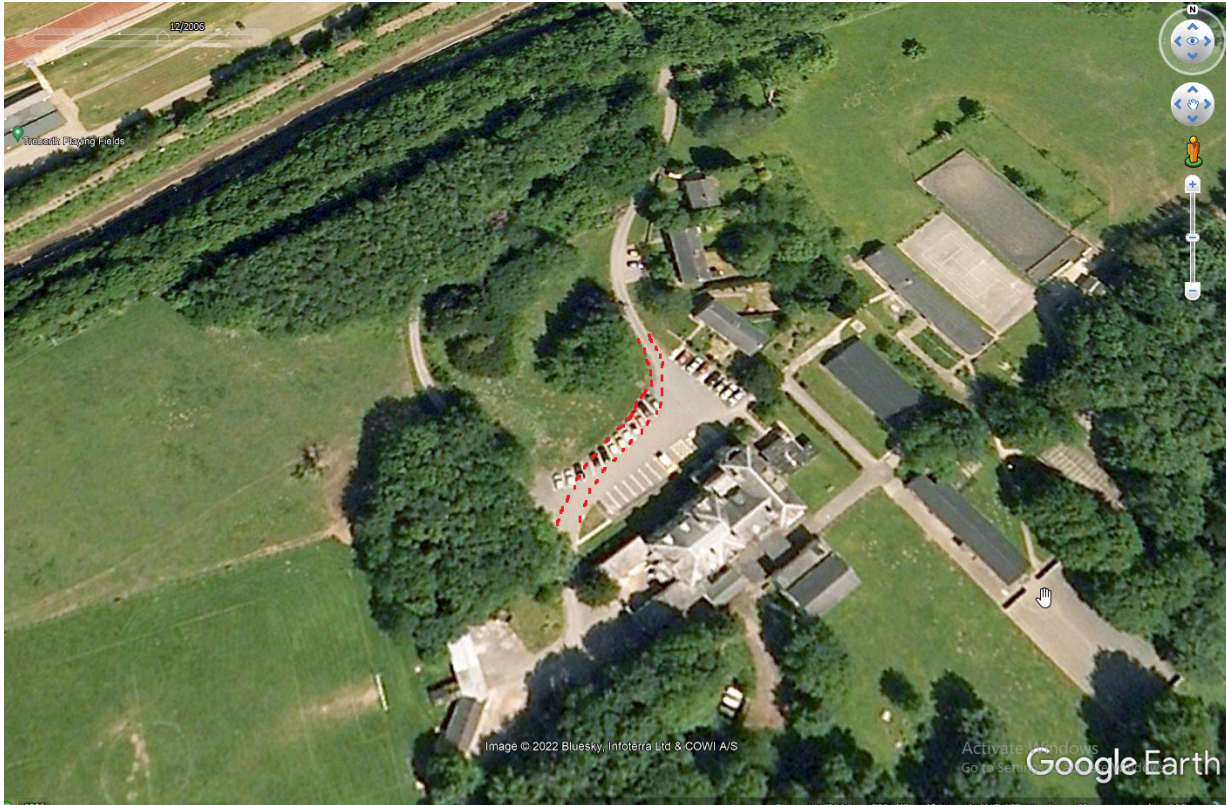

Photograph 3 - Google Earth 2009

Clear image of car parking spaces on the proposed route.



Photograph 4 - Photograph taken when the school was closed and steel clad c.2013
Further evidence of cars parking on the specific proposed route (indicated in red).



Photograph 5 - Additional Evidence from the Auction Catalogue
Cars parked on the car park on the proposed route.



Photograph 6 - Google Earth 2017

Clear image of the specific route (lighter grey) for vehicle access to the neighbouring properties due to usage by vehicles (shown in red). In 2015 we repositioned the boundary stones (shown in yellow) from the grass central island to the tarmac where they are positioned currently. The specific proposed route in front of the Hall as denoted by the white border stones never existed prior to 2015.



Treborth Botanic Garden

Wales Coastal Footpath

In October 2012 the Vice-Chancellor of Bangor University, Professor John G. Hughes, opened the latest section of the Wales Coast Path at the University's Treborth Botanic Garden. The new path runs in an elevated position parallel to the Menai Strait through the Garden's beautiful mixed woodland.



It follows the route of a historic carriageway which originally conveyed visitors from the Suspension Bridge to a ferry point half way between the two famous bridges, from where a boatman rowed passengers to Ynys Gored Goch to enjoy whitebait teas.

The Coast Path is open to everyone and is funded by the Welsh Government, supplemented by European Funding and administered through Gwynedd County Council's Coastal Access Team.



The new path includes a section suitable for wheelchair users. Information relating to the history and wildlife of the woodland is provided along the route.

Users are requested to respect the peace and tranquillity of the site which is also a Site of Special Scientific Interest and an Area of Outstanding Natural Beauty.

The wildlife interest is considerable and includes recent sightings of Red Squirrel – consequently all dogs should be kept on a lead through both the Botanic Garden and the woodland. For safety and enjoyment of pedestrian users, cycling is not permitted.



Re: Request for Information - Treborth Hall 06/10/23

From: [REDACTED]

To: w.jones@bangor.ac.uk

Date: Wednesday, 15 November 2023 at 13:15 GMT

Good afternoon Mr Jones

Thank you for your reply below.

As previously stated we were given a key for the yellow barrier before the railway bridge. Do you know when this yellow barrier was installed, why it was installed and who was responsible for it's operation? It appears this yellow barrier is very old.

This yellow barrier was locked when we purchased our property. We assume the school/GCC and the University operated this barrier for security reasons and it was locked on a regular basis? Can you confirm this please?

Could you please also confirm whether the yellow barrier was used by the University when there was a problem with young drivers prior to our ownership in 2014?

To clarify, is Gwynedd County Council responsible for the maintenance of the road/gate and barrier through the Botanic Garden? We understand they are responsible for the railway bridge.

Could you please give us any information the Estates Department has with regard to the above please?

We are sorry to burden you with these questions.

Kind regards

Mark and Susan Margetson

On Monday, 6 November 2023 at 16:35:35 GMT, Wayne Jones (Staff) <[REDACTED]> wrote:

Good morning Mr and Mrs Margetson,

Reference your email below:

- Your Estates Department issued the gate keys (including the yellow barrier by the railway bridge) to our son James who collected them on our behalf on 25 September 2014 from the University Estates Office on the Ffriddoedd site. This arrangement was made by Mr A G Jones per the copy emails attached. Therefore the University Estates Department should have a record of this. - ***apart from the email exchange that you kindly provided, there is no formal record within the Estates database of the keys being handed over. We do not have access to personal email accounts and therefore would not have had sight of this.***
- As we have a legal right to access our property through the Botanic Garden, the University should have informed us regarding the operation of this gate - ***your legal right of way was not adversely impacted.***
- Clearly the gate was being locked overnight since 2014 and your staff at the Botanic Garden/Security should be able to inform you when this gate stopped being locked at night. Again, we would be grateful if you could inform us of at least an approximate date when the University decided to stop locking this gate - ***Approximately 2018.***
- We assume that if a problem arises again, for instance with young drivers, the University will begin to lock the gate again at night? - ***if this problem arises again, we will review the issue and take action as appropriate.***
- The closing of our gate from Treborth Road on our property has clearly prevented problems with vehicular traffic passing through both our property and the Botanic Garden. Dr Shaun Russell, the previous Director of the Botanic Garden, was strongly in favour of the gating of both our properties for security reasons. We are surprised the University has stopped locking their gate.
- We would be further grateful if you could inform us whether to your knowledge there has always been a gate near the Lodge on University property for security purposes - ***I don't know if there was always a gate at the lodge.***

With best regards,
Wayne

Wayne Jones
 Pennaeth Rheoli Ystadau
 Gwasanaethau Campws

E-bost: [REDACTED]
 Ffôn: 01248 383607

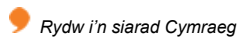

Wayne Jones
 Head of Estates Management
 Campus Services

Email: [REDACTED]
 Phone: 01248 383607



From: [REDACTED] <[REDACTED]>
Sent: 06 October 2023 10:29
To: Wayne Jones (Staff) <w.jones@bangor.ac.uk>
Subject: Re: Request for Information - Treborth Hall 06/10/23

Good morning Mr Jones

Further to your email below, we wish to comment as follows:

Your Estates Department issued the gate keys (including the yellow barrier by the railway bridge) to our son James who collected them on our behalf on 25 September 2014 from the University Estates Office on the Ffriddoedd site. This arrangement was made by Mr A G Jones per the copy emails attached. Therefore the University Estates Department should have a record of this.

As we have a legal right to access our property through the Botanic Garden, the University should have informed us regarding the operation of this gate.

Clearly the gate was being locked overnight since 2014 and your staff at the Botanic Garden/Security should be able to inform you when this gate stopped being locked at night. Again, we would be grateful if you could inform us of at least an approximate date when the University decided to stop locking this gate.

We assume that if a problem arises again, for instance with young drivers, the University will begin to lock the gate again at night?

The closing of our gate from Treborth Road on our property has clearly prevented problems with vehicular traffic passing through both our property and the Botanic Garden. Dr Shaun Russell, the previous Director of the Botanic Garden, was strongly in favour of the gating of both our properties for security reasons. We are surprised the University has stopped locking their gate.

We would be further grateful if you could inform us whether to your knowledge there has always been a gate near the Lodge on University property for security purposes.

Your response to the above would be much appreciated.

Kind regards

Susan and Mark Margetson
 Treborth Hall

On Monday, 7 August 2023 at 09:26:51 BST, Wayne Jones (Staff) <[REDACTED]>

Good morning, reference your email relating to the sign, I have tasked one of the team to attend this week, hopefully this will be resolved soon.

Relating to the gate and your specific queries:

If the University no longer locks the gate, could you please confirm the following:

1. *When did the University stop locking this gate? - I cannot find a specific date as to when it was decided to stop locking the gate.*
2. *Why did the University stop locking this gate? - as far as I can ascertain, the gate was locked to prevent vehicles (usually young drivers) from accessing the site late at night and speeding along the roadway. This doesn't seem to be an issue anymore and therefore the gate is no longer locked.*
3. *Why did the University not inform us? - there is no formal record of any handover of keys within our files/folders and therefore there wouldn't have been anything to prompt colleagues to inform you of the change. Please note, Nigel Brown was the curator of the garden and not part of the BU Estates team, he didn't have the authority to issue keys or approve any changes (if applicable) to access arrangements etc.*

With best regards,
 Wayne

Wayne Jones
Pennaeth Rheoli Ystadau
Gwasanaethau Campws

E-bost: [REDACTED]
Ffôn: 01248 383607

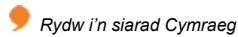

Wayne Jones
Head of Estates Management
Campus Services

Email: [REDACTED]
Phone: 01248 383607



From: [REDACTED] <[REDACTED]>
Sent: 03 August 2023 17:18
To: Wayne Jones (Staff) <w.jones@bangor.ac.uk>
Subject: Request for Information - Treborth Hall 03/08/23

Good afternoon Mr Jones

We refer to our emails to you dated 14 March 2023 and 20 June 2023 (please see below).

We would be grateful if you could provide a response.

Kind regards

Susan and Mark Margetson
Treborth Hall

----- Forwarded message -----

From: [REDACTED] <[REDACTED]>
To: Wayne Jones (Staff) <w.jones@bangor.ac.uk>
Sent: Tuesday, 20 June 2023 at 15:45:32 BST
Subject: Request for Information - Treborth Hall 20/06/23

Dear Mr Jones

Apologies for the late response to your email, which has been in part to the unexpected death of my husband's brother.

Firstly we wish to thank you for contacting the group associated with the "Toad Patrol Event" to prevent further uninvited trespass onto our land via the University Treborth Botanic Garden. Your kind assistance in this matter is appreciated.

Secondly please see below correspondence upon purchase of the Hall between ourselves and Gwynedd Council. As you can see Paragraph 4 refers to the collection of keys from your Estates Department (via your former Curator Nigel Brown) to enable our legal right of access via the Botanic Garden per our land title. These keys were required and provided to us by your Estates Department as both the entrance gate and yellow barrier were locked by the University at night.

-----Original Message-----

From: Owen Lowri Cadwaladr (Rh-CTGC) <[REDACTED]>
To: classicmarque <[REDACTED]>
Sent: Wed, 30 Jul 2014 16:55
Subject: RE: TREBORTH HALL - SECURITY ARRANGEMENTS - REPLY

Good afternoon,

Apologies for the delay in reply, I have been out of the office for most of the day.

We have contacted VPS to arrange for removal of the cameras and alarms and have been informed that they will carry out this work on Friday morning. They hope to be at the property for 10.00 to 10.30 and I understand that the work will take about an hour to an hour and a half to complete.

We are happy for the security fencing to remain at the property for the time being.

A key to the gate on the Treborth Road access has previously been provided. Treborth Botanical Gardens are owned by Bangor University, and keys for the lodge gate and barrier (if in use) will need to be obtained via the curator of the Botanical Gardens Nigel Brown who can be contacted using the following e-mail address:- [REDACTED]

Unfortunately, we do not appear to have keys for the electric fuse and gas boxes. All keys available are held by Mr Christy and will be handed over on Friday.

I have made some enquiries with our maintenance team however we have been unable to trace any documentation relating to the heating and electrical systems.

Would you be available to meet on site at 10.00am. I have another meeting arranged in Caernarfon which is scheduled to finish at 10.00, and if I am unable to re-arrange, I shall arrange for a colleague to be present.

Kind regards,

Lowri Owen

We would therefore be grateful if you could provide the information we have previously requested, i.e. if the University Botanic Garden entrance gate is no longer locked at night could you please inform us from when, for what reason and why, as a keyholder, we were not informed by the University.

We appreciate your kind assistance in this matter, which clearly has an impact on the security of the Hall.

Kind regards

Mark and Susan Margetson

On Tuesday, 2 May 2023 at 10:53:06 BST, Wayne Jones (Staff) <[REDACTED]> wrote:

Good morning to you both, my apologies for not replying sooner, I've had a period of illness and intermittent annual leave and I'm only just catching-up with emails.

In reference to your email below, can you provide some further information on the agreement to provide you with a key to the gate. I have reviewed our maintenance records, going back to 1st Jan 2010 and I don't have anything relating to the gate install.

I have also reviewed your email regarding the 'Toad Patrol Event' that happened on the 16th March 2023. I can confirm, this was not a University managed or commissioned event, it would appear the group used Treborth as a meeting point. However, we have contacted the group and issued them with the relevant information regarding access and egress from site.

With best regards,
Wayne

Wayne Jones
Pennaeth Rheoli Ystadau
Gwasanaethau Campws

E-bost: [REDACTED]
Ffôn: 01248 383607

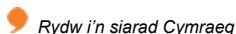

Wayne Jones
Head of Estates Management
Campus Services

Email: [REDACTED]
Phone: 01248 383607



From: [REDACTED] <[REDACTED]>
Sent: 14 March 2023 13:45
To: Wayne Jones (Staff) <[REDACTED]>
Subject: Complaint - Staff members/affiliated personnel at Bangor University Treborth Botanic Garden / Query re Gate

Dear Mr Jones

We thank you for your response to the above and apologise for the delay in our response.

For your information we are no further forward on this matter.

In the meantime we would be grateful if you could confirm the position of the closing and locking of the Botanic Garden entrance gate adjacent to the Lodge.

When we purchased the Hall in 2014 we were given a key to this gate, as it was locked every night. We assume the University began locking this gate when it was installed? We would be grateful if you could tell us when this was.

If the University no longer locks the gate, could you please confirm the following:

1. When did the University stop locking this gate?
2. Why did the University stop locking this gate?
3. Why did the University not inform us?

We would be grateful of your reply in due course.

We thank you for your assistance in this matter.

Kind regards

Mark and Susan Margetson
Treborth Hall

Mae croeso i chi gysylltu gyda'r Brifysgol yn Gymraeg neu Saesneg. Ni fydd gohebu yn Gymraeg yn arwain at oedi.

You are welcome to contact the University in Welsh or English. Corresponding in Welsh will not lead to delay.

Rhif Elusen Gofrestredig 1141565 - Registered Charity No. 1141565

Gall y neges e-bost hon, ac unrhyw atodiadau a anfonwyd gyda hi, gynnwys deunydd cyfrinachol ac wedi eu bwriadu i'w defnyddio'n unig gan y sawl y cawsant eu cyfeirio ato (atynt). Os ydych wedi derbyn y neges e-bost hon trwy gamgymeriad, rhoch wybod i'r anfonwr ar unwaith a dilewch y neges. Os na fwriadwyd anfon y neges atoch chi, rhaid i chi beidio a defnyddio, cadw neu ddatgelu unrhyw wybodaeth a gynhwysir ynddi. Mae unrhyw farn neu safbwynt yn eiddo i'r sawl a'i hanfonodd yn unig ac nid yw o anghenraid yn cynrychioli barn Prifysgol Bangor. Nid yw Prifysgol Bangor yn gwarantu bod y neges e-bost hon neu unrhyw atodiadau yn rhydd rhag frysau neu 100% yn ddiogel. Oni bai fod hyn wedi ei ddatgan yn uniongyrchol yn nhestun yr e-bost, nid bwriad y neges e-bost hon yw ffurfio contract rhwymol - mae rhestr o lofnodwyr awdurdodedig ar gael o Swyddfa Cyllid Prifysgol Bangor.

This email and any attachments may contain confidential material and is solely for the use of the intended recipient(s). If you have received this email in error, please notify the sender immediately and delete this email. If you are not the intended recipient(s), you must not use, retain or disclose any information contained in this email. Any views or opinions are solely those of the sender and do not necessarily represent those of Bangor University. Bangor University does not guarantee that this email or any attachments are free from viruses or 100% secure. Unless expressly stated in the body of the text of the email, this email is not intended to form a binding contract - a list of authorised signatories is available from the Bangor University Finance Office.

Mae croeso i chi gysylltu gyda'r Brifysgol yn Gymraeg neu Saesneg. Ni fydd gohebu yn Gymraeg yn arwain at oedi.

You are welcome to contact the University in Welsh or English. Corresponding in Welsh will not lead to delay.

Rhif Elusen Gofrestredig 1141565 - Registered Charity No. 1141565

Gall y neges e-bost hon, ac unrhyw atodiadau a anfonwyd gyda hi, gynnwys deunydd cyfrinachol ac wedi eu bwriadu i'w defnyddio'n unig gan y sawl y cawsant eu cyfeirio ato (atynt). Os ydych wedi derbyn y neges e-bost hon trwy gamgymeriad, rhoch wybod i'r anfonwr ar unwaith a dilewch y neges. Os na fwriadwyd anfon y neges atoch chi, rhaid i chi beidio a defnyddio, cadw neu ddatgelu unrhyw wybodaeth a gynhwysir ynddi. Mae unrhyw farn neu safbwynt yn eiddo i'r sawl a'i hanfonodd yn unig ac nid yw o anghenraid yn cynrychioli barn Prifysgol Bangor. Nid yw Prifysgol Bangor yn gwarantu bod y neges e-bost hon neu unrhyw atodiadau yn rhydd rhag frysau neu 100% yn ddiogel. Oni bai fod hyn wedi ei ddatgan yn uniongyrchol yn nhestun yr e-bost, nid bwriad y neges e-bost hon yw ffurfio contract rhwymol - mae rhestr o lofnodwyr awdurdodedig ar gael o Swyddfa Cyllid Prifysgol Bangor.

This email and any attachments may contain confidential material and is solely for the use of the intended recipient(s). If you have received this email in error, please notify the sender immediately and delete this email. If you are not the intended recipient(s), you must not use, retain or disclose any information contained in this email. Any views or opinions are solely those of the sender and do not necessarily represent those of Bangor University. Bangor University does not guarantee that this email or any attachments are free from viruses or 100% secure. Unless expressly stated in the body of the text of the email, this email is not intended to form a binding contract - a list of authorised signatories is available from the Bangor University Finance Office.

Mae croeso i chi gysylltu gyda'r Brifysgol yn Gymraeg neu Saesneg. Ni fydd gohebu yn Gymraeg yn arwain at oedi.

You are welcome to contact the University in Welsh or English. Corresponding in Welsh will not lead to delay.

Rhif Elusen Gofrestredig 1141565 - Registered Charity No. 1141565

Gall y neges e-bost hon, ac unrhyw atodiadau a anfonwyd gyda hi, gynnwys deunydd cyfrinachol ac wedi eu bwriadu i'w defnyddio'n unig gan y sawl y cawsant eu cyfeirio ato (atynt). Os ydych wedi derbyn y neges e-bost hon trwy gamgymeriad,

rhochwybod i'r anfonwr ar unwaith a dilewch y neges. Os na fwriadwyd anfon y neges atoch chi, rhaid i chi beidio a defnyddio, cadw neu ddatgelu unrhyw wybodaeth a gynhwysir ynddi. Mae unrhyw farn neu safbwynt yn eiddo i'r sawl a'i hanfonodd yn unig ac nid yw o anghenraid yn cynrychioli barn Prifysgol Bangor. Nid yw Prifysgol Bangor yn gwarantu bod y neges e-bost hon neu unrhyw atodiadau yn rhydd rhag firsau neu 100% yn ddiogel. Oni bai fod hyn wedi ei ddatgan yn uniongyrchol yn nhestun yr e-bost, nid bwriad y neges e-bost hon yw ffurfio contract rhwymol - mae rhestr o lofnodwyr awdurdodedig ar gael o Swyddfa Cyllid Prifysgol Bangor.

This email and any attachments may contain confidential material and is solely for the use of the intended recipient(s). If you have received this email in error, please notify the sender immediately and delete this email. If you are not the intended recipient(s), you must not use, retain or disclose any information contained in this email. Any views or opinions are solely those of the sender and do not necessarily represent those of Bangor University. Bangor University does not guarantee that this email or any attachments are free from viruses or 100% secure. Unless expressly stated in the body of the text of the email, this email is not intended to form a binding contract - a list of authorised signatories is available from the Bangor University Finance Office.

From: [REDACTED]**To:** [REDACTED]**Subject:** Re: Treborth Hall - Botanical Garden Access -Reply**Date:** Thu, 18 Sep 2014 14:31

Dear Mark and Susan

I am sorry that you have had no response yet from my colleagues in Estates - I have just emailed them again to ask them to resolve this asap.

Please let me know if you do not hear back from them by Monday.

kind regards

Nigel

From: [REDACTED] <[REDACTED]>**Sent:** 18 September 2014 14:01**To:** Nigel Brown**Subject:** Re: Treborth Hall - Botanical Garden Access -Reply

|

Dear Mr Brown,

We have still not received the key or any reply from your colleagues.

We would be grateful of your further assistance in this matter.

Kind regards

Mark and Susan Margetson

-----Original Message-----

From: classicmarque <[REDACTED]>

To: n.brown <[REDACTED]>

Sent: Tue, 2 Sep 2014 14:06

Subject: Re: Treborth Hall - Botanical Garden Access -Reply

Afternoon Mr Brown

Apologies for not responding to you sooner.

We would both like to thank you for your kind welcoming message and for arranging a key for access.

We look forward to hearing from the University Estates Department in due course.

Thank you for your assistance in this matter.

Kind Regards

Mark and Susan Margetson

Sent from AOL Mobile Mail

-----Original Message-----

From: Nigel Brown <[REDACTED]>
To: classicmarque <[REDACTED]>
CC: Ceri Roberts <[REDACTED]>; Clive Jones <[REDACTED]>; John Owen
<[REDACTED]>
Sent: Thu, Aug 28, 2014 03:04 PM
Subject: RE: Treborth Hall - Botanical Garden Access

Dear Mr and Mrs Margetson

Welcome to Treborth - thank you for your email - I am copying this reply to my colleagues in the University's Estates dept who will be in touch with you as soon as possible.

Kind regards

Nigel Brown, curator, Treborth Botanic Garden, Bangor University

From: [REDACTED] <[REDACTED]>
Sent: 28 August 2014 14:01
To: Nigel Brown
Subject: Treborth Hall - Botanical Garden Access

Dear Mr Brown,

We are the new owners of Treborth Hall and have been given your name and email address from Lowri Owen at Gwynedd Council.

We would be grateful if we could arrange a mutually convenient time when we can collect a copy key from you for the lock to the entrance gate of the Botanical Gardens.

We look forward to hearing from you in due course.

Kind regards

M I & S E Margetson

Rhif Elusen Gofrestredig 1141565 - Registered Charity No. 1141565

Gall y neges e-bost hon, ac unrhyw atodiadau a anfonwyd gyda hi, gynnwys deunydd cyfrinachol ac wedi eu bwriadu i'w defnyddio'n unig gan y sawl y cawsant eu cyfeirio ato (atynt). Os ydych wedi derbyn y neges e-bost hon trwy gamgymeriad, rhoch wybod i'r anfonwr ar unwaith a dilewch y neges. Os na fwriadwyd anfon y neges atoch chi, rhaid i chi beidio a defnyddio, cadw neu ddatgelu unrhyw wybodaeth a gynhwysir ynddi. Mae unrhyw farn neu safbwynt yn eiddo i'r sawl a'i hanfonodd yn unig ac nid yw o anghenraid yn cynrychioli barn Prifysgol Bangor. Nid yw Prifysgol Bangor yn gwarantu bod y neges e-bost hon neu unrhyw atodiadau yn rhydd rhag ffrysau neu 100% yn ddiogel. Oni bai fod hyn wedi ei ddatgan yn uniongyrchol yn nhestun yr e-bost, nid bwriad y neges e-bost hon yw ffurfio contract rhwymol - mae rhestr o lofnodwyr awdurdodedig ar gael o Swyddfa Cyllid Prifysgol Bangor.

This email and any attachments may contain confidential material and is solely for the use of the intended recipient(s). If you have received this email in error, please notify the sender immediately and delete this email. If you are not the intended recipient(s), you must not use, retain or disclose any information contained in this email. Any views or opinions are solely those of the sender and do not necessarily represent those of Bangor University. Bangor University does not guarantee that this email or any attachments are free from viruses or 100% secure. Unless expressly stated in the body of the text of the

email, this email is not intended to form a binding contract - a list of authorised signatories is available from the Bangor University Finance Office.

Rhif Elusen Gofrestredig 1141565 - Registered Charity No. 1141565

Gall y neges e-bost hon, ac unrhyw atodiadau a anfonwyd gyda hi, gynnwys deunydd cyfrinachol ac wedi eu bwriadu i'w defnyddio'n unig gan y sawl y cawsant eu cyfeirio ato (atynt). Os ydych wedi derbyn y neges e-bost hon trwy gamgymeriad, rhowch wybod i'r anfonwr ar unwaith a dilewch y neges. Os na fwriadwyd anfon y neges atoch chi, rhaid i chi beidio a defnyddio, cadw neu ddatgelu unrhyw wybodaeth a gynhwysir ynddi. Mae unrhyw farn neu safbwynt yn eiddo i'r sawl a'i hanfonodd yn unig ac nid yw o anghenraid yn cynrychioli barn Prifysgol Bangor. Nid yw Prifysgol Bangor yn gwarantu bod y neges e-bost hon neu unrhyw atodiadau yn rhydd rhag frysau neu 100% yn ddiogel. Oni bai fod hyn wedi ei ddatgan yn uniongyrchol yn nhestun yr e-bost, nid bwriad y neges e-bost hon yw ffurfio contract rhwymol - mae rhestr o lofnodwyr awdurdodedig ar gael o Swyddfa Cyllid Prifysgol Bangor.

This email and any attachments may contain confidential material and is solely for the use of the intended recipient(s). If you have received this email in error, please notify the sender immediately and delete this email. If you are not the intended recipient(s), you must not use, retain or disclose any information contained in this email. Any views or opinions are solely those of the sender and do not necessarily represent those of Bangor University. Bangor University does not guarantee that this email or any attachments are free from viruses or 100% secure. Unless expressly stated in the body of the text of the email, this email is not intended to form a binding contract - a list of authorised signatories is available from the Bangor University Finance Office.

From: [REDACTED]

To: [REDACTED]

Subject: RE: Gate Key, Treborth - Collection

Date: Wed, 24 Sep 2014 14:56

Attachments:

That should be fine. I'll inform our reception.

Regards

Alwyn

Sent from my Windows Phone

From: [REDACTED]

Sent: 24/09/2014 13:22

To: [Alwyn Jones](#)

Subject: Re: Gate Key, Treborth - Collection

Good Afternoon Alwyn

Thank you for your email.

We would be grateful if our son James could collect the Treborth gate key from your offices tomorrow morning.

Many thanks for your assistance.

Kind Regards

Mark and Susan Margetson
Treborth Hall

Sent from AOL Mobile Mail

-----Original Message-----

From: Alwyn Jones <[REDACTED]>

To: classicmarque <[REDACTED]>

Cc: Derwyn Owen <derwyn.owen@bangor.ac.uk>

Sent: Mon, Sep 22, 2014 12:19 PM

Subject: Gate Key, Treborth

Dear Mr & Mrs Margeston,

We have now received the ordered copy of the suited key for the gate at Treborth.

You can pick the key up at our offices on Victoria Drive anytime between 9.00 am and 5.00 pm Monday to Friday.

Please confirm when you will collect so that I can ensure that our reception staff are expecting you.

Best regards,

Alwyn

Alwyn G Jones BSc (Hons)

Rheolwr Cynnal a Chadw Adeiladau
Prifysgol Bangor
Ystadau a Chyfleusterau

Building Maintenance Manager
Bangor University
Estates and Facilities

Ffôn: +44 (0) 1248 382783/4
Ebst: [REDACTED]

Tel: +44 (0) 1248 382783/4
Email: [REDACTED]



www.bangor.ac.uk

Rhif Elusen Gofrestredig 1141565 - Registered Charity No. 1141565

Gall y neges e-bost hon, ac unrhyw atodiadau a anfonwyd gyda hi, gynnwys deunydd cyfrinachol ac wedi eu bwriadu i'w defnyddio'n unig gan y sawl y cawsant eu cyfeirio ato (atynt). Os ydych wedi derbyn y neges e-bost hon trwy gamgymeriad, rhwch wybod i'r anfonwr ar unwaith a dilewch y neges. Os na fwriadwyd anfon y neges atoch chi, rhaid i chi beidio a defnyddio, cadw neu ddatgelu unrhyw wybodaeth a gynhwysir ynddi. Mae unrhyw farn neu safbwynt yn eiddo i'r sawl a'i hanfonodd yn unig ac nid yw o anghenraid yn cynrychioli barn Prifysgol Bangor. Nid yw Prifysgol Bangor yn gwarantu bod y neges e-bost hon neu unrhyw atodiadau yn rhydd rhag firysau neu 100% yn ddiogel. Oni bai fod hyn wedi ei ddatgan yn uniongyrchol yn nhestun yr e-bost, nid bwriad y neges e-bost hon yw ffurfio contract rhwymol - mae rhestr o lofnodwyr awdurdodedig ar gael o Swyddfa Cyllid Prifysgol Bangor.

This email and any attachments may contain confidential material and is solely for the use of the intended recipient(s). If you have received this email in error, please notify the sender immediately and delete this email. If you are not the intended recipient(s), you must not use, retain or disclose any information contained in this email. Any views or opinions are solely those of the sender and do not necessarily represent those of Bangor University. Bangor University does not guarantee that this email or any attachments are free from viruses or 100% secure. Unless expressly stated in the body of the text of the email, this email is not intended to form a binding contract - a list of authorised signatories is available from the Bangor University Finance Office.

Rhif Elusen Gofrestredig 1141565 - Registered Charity No. 1141565

Gall y neges e-bost hon, ac unrhyw atodiadau a anfonwyd gyda hi, gynnwys deunydd cyfrinachol ac wedi eu bwriadu i'w defnyddio'n unig gan y sawl y cawsant eu cyfeirio ato (atynt). Os ydych wedi derbyn y neges e-bost hon trwy gamgymeriad, rhowch wybod i'r anfonwr ar unwaith a dilewch y neges. Os na fwriadwyd anfon y neges atoch chi, rhaid i chi beidio a defnyddio, cadw neu ddatgelu unrhyw wybodaeth a gynhwysir ynddi. Mae unrhyw farn neu safbwynt yn eiddo i'r sawl a'i hanfonodd yn unig ac nid yw o anghenraid yn cynrychioli barn Prifysgol Bangor. Nid yw Prifysgol Bangor yn gwarantu bod y neges e-bost hon neu unrhyw atodiadau yn rhydd rhag ffirysau neu 100% yn ddiogel. Oni bai fod hyn wedi ei ddatgan yn uniongyrchol yn nhestun yr e-bost, nid bwriad y neges e-bost hon yw ffurfio contract rhwymol - mae rhestr o lofnodwyr awdurdodedig ar gael o Swyddfa Cyllid Prifysgol Bangor.

This email and any attachments may contain confidential material and is solely for the use of the intended recipient(s). If you have received this email in error, please notify the sender immediately and delete this email. If you are not the intended recipient(s), you must not use, retain or disclose any information contained in this email. Any views or opinions are solely those of the sender and do not necessarily represent those of Bangor University. Bangor University does not guarantee that this email or any attachments are free from viruses or 100% secure. Unless expressly stated in the body of the text of the email, this email is not intended to form a binding contract - a list of authorised signatories is available from the Bangor University Finance Office.

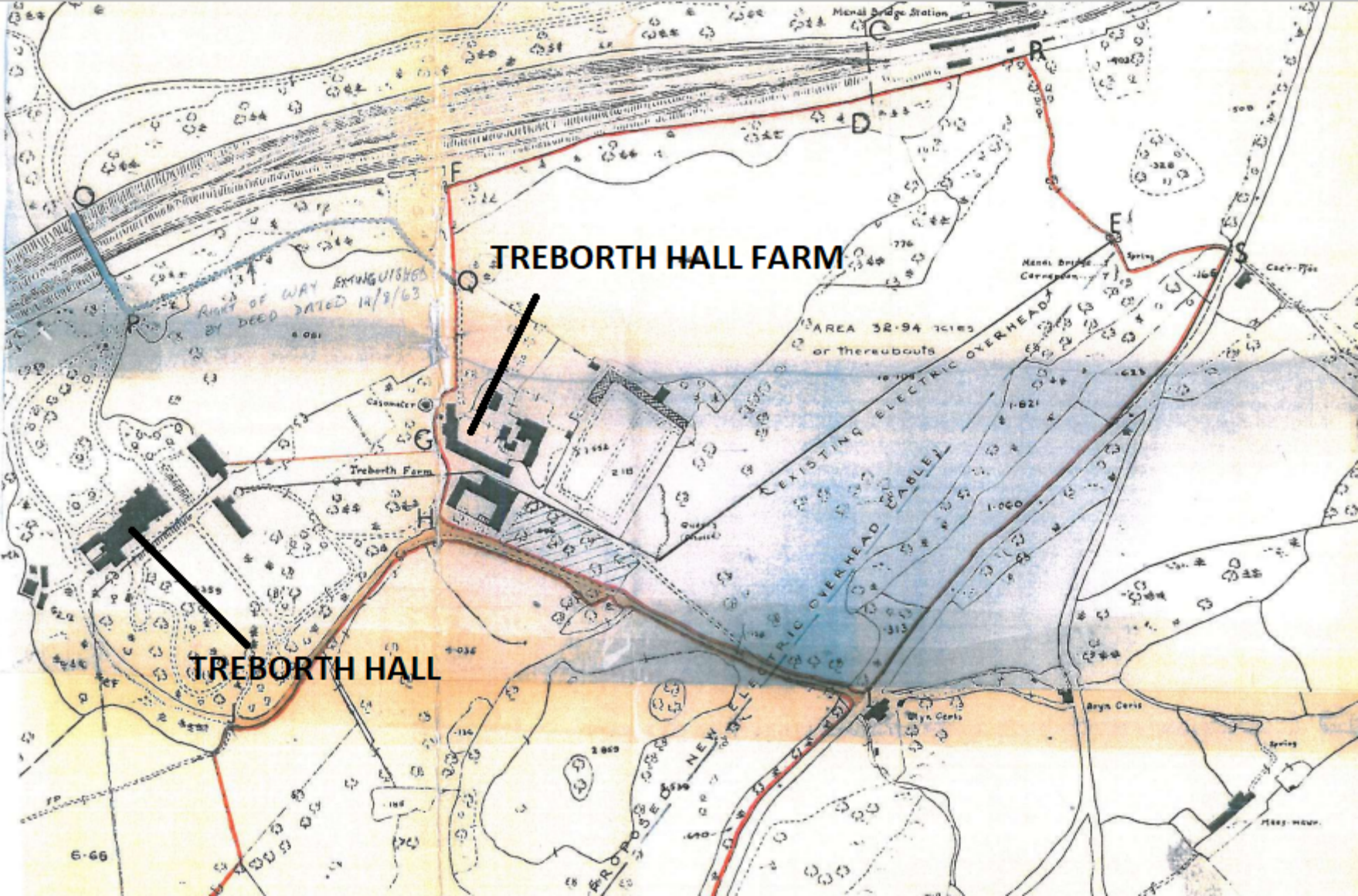





Treborth

Swyddfa Rivendell Rivendell Office

Cyfarwyddwr a Gweinyddwr
Administrator

den yn bob amn
ead aml yn en



R

Richard Jones - Former Pupil 1972 to 1978 >

Yesterday 10:58

Good morning Richard. Hope you're both ok. We are doing a bit of research on the school. Just out of interest do you remember the big yellow barrier by the railway bridge when you were at school? Thanks

Yes I do remember a barrier but can't remember the colour

We were told not to go near the railway bridge

Did the school close the barrier and lock it?

Can't remember but I will text Tristan to see if he can shed any light on that, hope both of you are keeping well

We are ok thanks but it could be warmer! Which way did you come to school - via the botanic garden



R

Richard Jones - Former Pupil 1972 to 1978 >

Can't remember but I will text Tristan to see if he can shed any light on that, hope both of you are keeping well

We are ok thanks but it could be warmer! Which way did you come to school - via the botanic garden and did you come in a taxi?

Yes over the old bridge past the botanic gardens, yes I did come by taxi, first thing Monday morning go home Friday afternoon

I remember you saying you attended during 1973-78 and you are the same age as me. Is Tristan the same approx age as us?

Did you all arrive and depart in taxis? It must have been busy!

It was 72 till 78 and Tristan is in his 50s we had a private taxi driver from Llangefni called Mr Roberts and he was my taxi driver all that time he was a lovely man sadly



Text Message

